

| TOWN HWY. NO. | LENGTH IN MILES CLASS 3 | LENGTH IN MILES CLASS 4 | |
|---------------|-------------------------|-------------------------|---------|
| 4 | 2.280 | 41 | 1.750 |
| 5 | 5.200 | 42 | (0.280) |
| 6 | 4.200 | 43 | 1.250 |
| 7 | 2.800 | 44 | 0.320 |
| 8 | (0.350) | 45 | (0.750) |
| 9 | 0.040 | 46 | 0.490 |
| 10 | 1.610 | 46 | (0.090) |
| 11 | 1.150 | 47 | 0.400 |
| 12 | 0.660 | 48 | 1.350 |
| 13 | 1.960 | 49 | (1.180) |
| 14 | (0.450) | 50 | 0.050 |
| 15 | 0.850 | 51 | 0.100 |
| 16 | 1.460 | 52 | 0.160 |
| 17 | (0.350) | 54 | (0.500) |
| 18 | 0.840 | 55 | 0.060 |
| 19 | 0.580 | 56 | 0.120 |
| 19 | (0.300) | 57 | 0.110 |
| 20 | 0.650 | 58 | (0.190) |
| 21 | 0.950 | 59 | (0.120) |
| 22 | 0.700 | 60 | 0.310 |
| 23 | 3.040 | 61 | 0.020 |
| 24 | 2.910 | 62 | 0.110 |
| 25 | 0.170 | 63 | 0.120 |
| 26 | 1.730 | 64 | 0.050 |
| 27 | 1.190 | 65 | 0.120 |
| 28 | 1.150 | 66 | 0.350 |
| 29 | (0.070) | 68 | 0.100 |
| 30 | 0.250 | 69 | 0.500 |
| 31 | 1.070 | 70 | (0.840) |
| 31 | (0.450) | 70 | (0.450) |
| 33 | 0.330 | 71 | 0.300 |
| 34 | (0.750) | 74 | 0.060 |
| 35 | 2.130 | 75 | (0.350) |
| 36 | 0.750 | 76 | (0.010) |
| 37 | 0.680 | 77 | (0.010) |
| 38 | 0.290 | 78 | (0.160) |
| 39 | 0.200 | | |
| 40 | 2.300 | | |
| TOTAL | 52.390 | 12.760 | |

* Portion of this town highway is Class 3, but is functionally Class 4

MILEAGE SUMMARY

| | | |
|----------------------|---------------|--|
| CLASS 2 | | |
| TH-1 | 4.630 | |
| TH-2 | 5.790 | |
| TH-3 | 5.320 | |
| TOTAL CLASS 2 | 15.740 | |
| CLASS 3 | | |
| TOTAL CLASS 3 | 52.390 | |
| TOTAL TOWN | 68.130 | |

TOTAL, TRAVELED HIGHWAYS, FEB. 10, 2005: 68.130
(Excludes Class 4 Mileage)

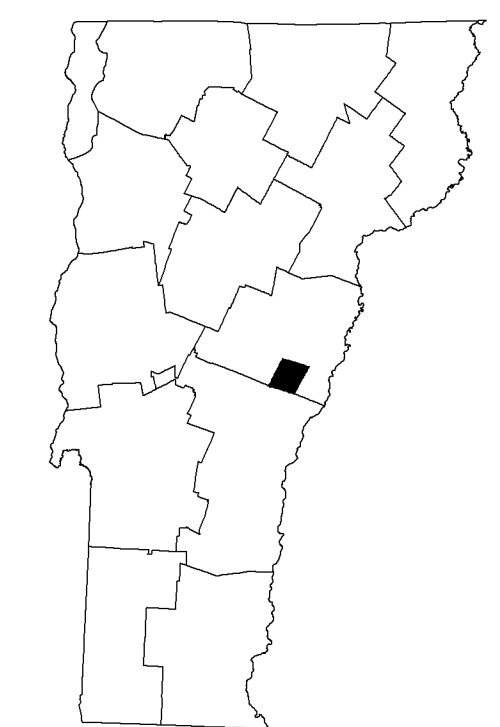
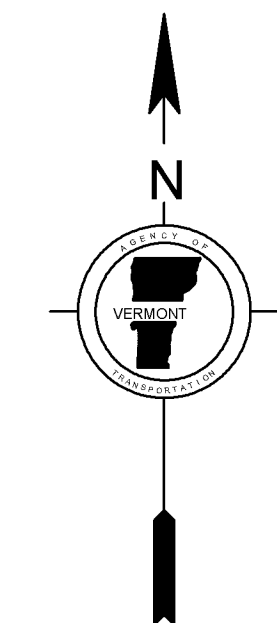
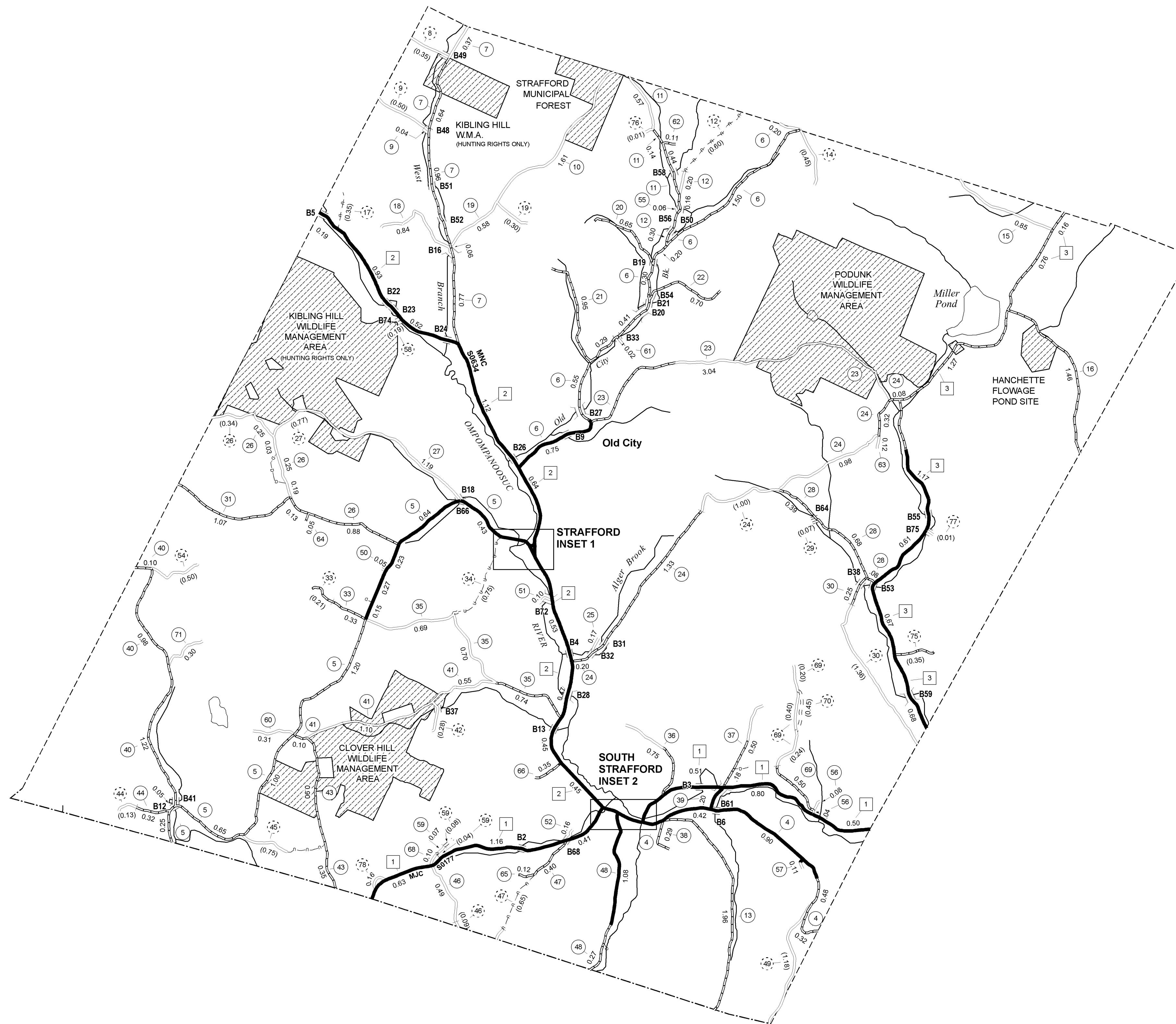

- HIGHWAYS**
- INTERSTATE
 - U.S. ROUTE
 - STATE ROUTE
 - CLASS 1
 - CLASS 2
 - CLASS 3
 - CLASS 4
 - STATE - HARD SURFACE OR PAVED
 - TOWN - HARD SURFACE OR PAVED
 - GRAVEL
 - SOIL OR GRADED AND DRAINED EARTH
 - UNIMPROVED OR PRIMITIVE
 - IMPASSABLE OR UNTRAVELED
 - LEGAL TRAIL
 - DISCONTINUED
 - HIGHWAY CLASS CHANGE
 - RAILROAD
- FEDERAL CLASSIFICATION IDENTIFIER**
- FAU URBAN ARTERIAL OR COLLECTOR
 - MA MINOR ARTERIAL
 - MJC MAJOR COLLECTOR
 - MNC MINOR COLLECTOR
 - PA PRINCIPAL ARTERIAL
- PUBLIC LAND**
- POLITICAL SUBDIVISIONS**
- STATE BOUNDARY
 - COUNTY BOUNDARY
 - TOWN BOUNDARY
 - VILLAGE BOUNDARY
 - URBAN COMPACT BOUNDARY
- WATER BODIES**
- OPEN WATER
 - SWAMP
 - STREAM OR BROOK
- BRIDGE OR CULVERT**
- BRIDGE OR CULVERT GREATER THAN 20'
 - BRIDGE OR CULVERT 6' - 20'
 - B34 STATE BRIDGE IDENTIFIER
 - B34 TOWN BRIDGE IDENTIFIER

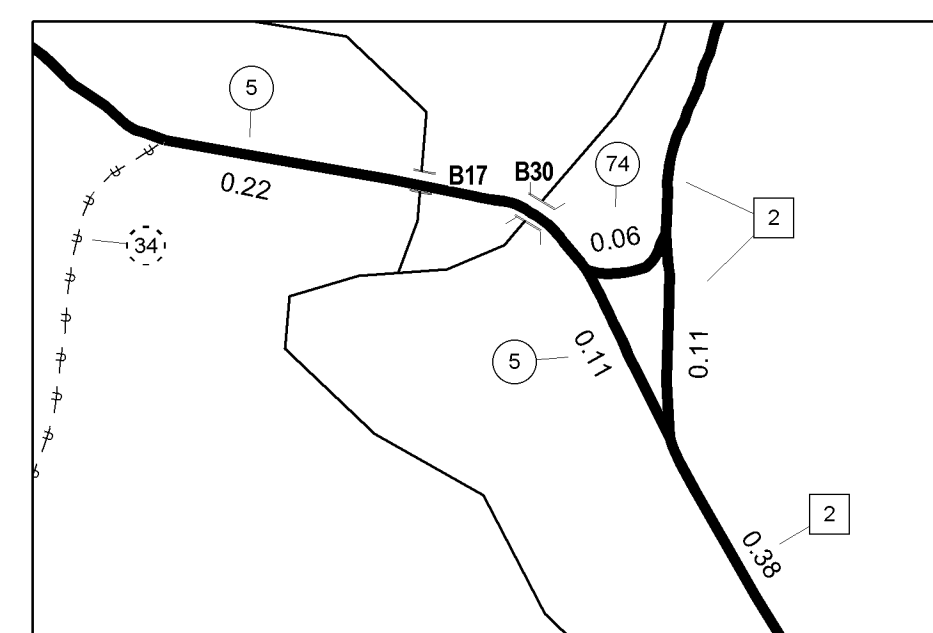

STRAFFORD INSET 1

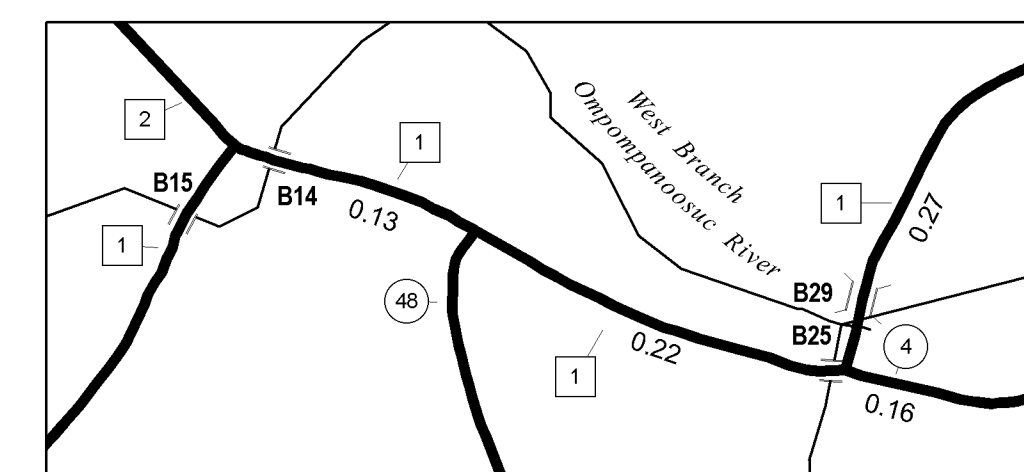

SOUTH STRAFFORD INSET 2

INSET SCALE 1:6336

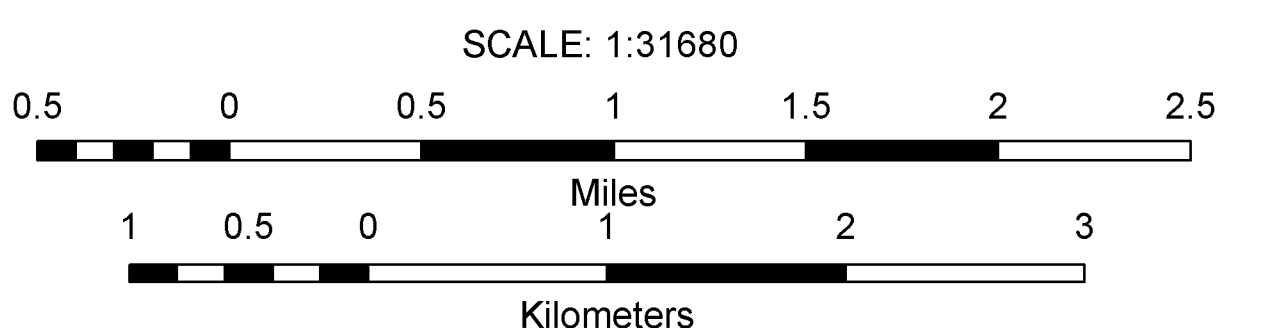
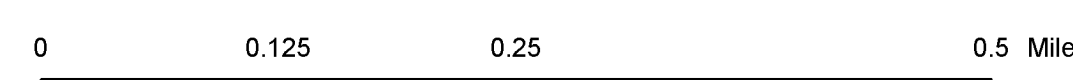

DISCLAIMER:
Highway and bridge data by the Agency of Transportation, Policy & Planning Division. All other data from the Vermont Center for Geographic Information.

